

TERPSEALS

Vacuum Seal Your Terpenes Like Never Before

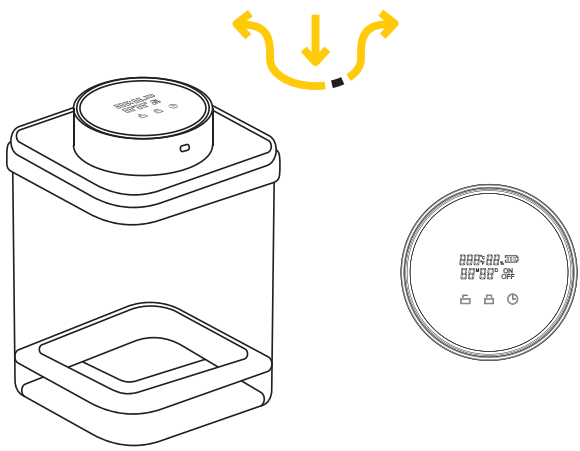

TERPSEALS – USER MANUAL

This manual contains usage instructions and important cautions, read it and store it!

WARNING: Do not use this product before reading the instructions. IT IS IMPORTANT TO READ CAREFULLY AND KEEP FOR FUTURE REFERENCE.

TERPSEALS FUNCTIONS

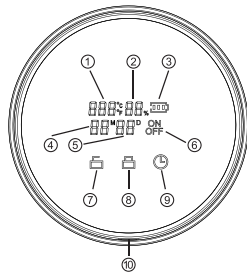

THE FIRST PROFESSIONAL ASPIRATOR

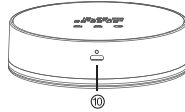

- 1) Terpseals Temperature Jar: Real time temperature indicator, Press the key to switch between Celsius/Fahrenheit.
- 2) Terpseals Humidity Jar: Real time Hygrometer.
- 3) Terpseals Jar battery: When the display is charging, the light on the display flashes; when it is fully charged, it stops.
- 4-5) Personalized Storage Record: To set the exact date of storage of your terp, press 3-5 seconds to set Day and Month.
- 6) Terpseals Automatic Vacuum Control: ON means the system is active, detecting the in-jar pressure automatically and fixing any air loss if detected. OFF means the system is turned off.
- 7) Terpseals Vacuum System Unlock: Press and hold for 3-5 seconds to Unseal.
- 8) Terpseals Vacuum system lock key: pres it once to start to seal and vacuum the jar. Press and hold for 3-5 seconds to pause and use the best seal for you!
- 9) Terpseals Store Time: Click Once To switch from F/C, Press and hold for 3-5 seconds to reset the time of storage.
- 10) Type C plug.

- 1 -

HOW TO USE TERPSEALS

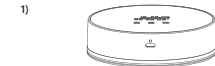

Place the Terpseals digital lid on top of the jar, making sure the seal adheres well to the jar structure.



Swipe your finger across the display to turn it on and interact with it. The display will automatically turn off after 5 seconds of inactivity.

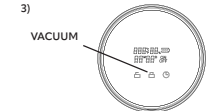

Press the button once to vacuum seal the inside of the jar. The display will show "On" indicating that the vacuum system is active.



Monitor the internal humidity using the digital display. Switch from Fahrenheit to Celsius by pressing the button once.



Reset the storage time by holding the button for 3-5 seconds until the calendar shows 00M 00D. From that moment, the month and day counter will begin. (Hours are not shown but are tracked by the calendar.

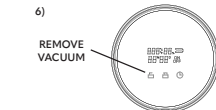

Hold the button for 3-5 seconds to release the vacuum and open the jar. Once opened, the display will show "OFF" as the vacuum system is deactivated.

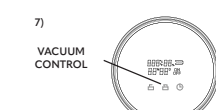

Press the button once to vacuum seal the jar. The display will show "On" indicating that the vacuum and vacuum control system are active. Every time a small amount of air (20% of the capacity) enters the jar, it will automatically re-seal. To deactivate the vacuum control, hold the button for 3-5 seconds. The display will show "OFF" indicating that vacuum control is off, although the jar remains vacuum sealed. To reactivate the vacuum control, press the button once.

- 2 -

PT.2 HOW TO USE TERPSEALS

- 1) Start: Insert the jar lid onto the Jar and make sure that the lid fits well.
- 2) Press the display: Press the display to light it up; the display stays on for 5 seconds.
- 3) Seal: Vacuum and seal the jar by holding down the button.
- 4) Unseal: Unseal the Jar by holding down the button.
- 5) Storage Time: Press the for 3-5 seconds to reset the the store time.
- 6) Time Display: stands for Day and for Month.
- 7) Automatic Vacuum: While you are storing, Terpseals will monitor the air pressure and vacuum conditions. When the negative pressure leakage exceeds a specific threshold, the system will initiate the vacuum process automatically and Seal it.
- 8) Temperature and Humidity: The display will show the real-time percentage of humidity and temperature inside the jar. You can switch between Fahrenheit and Celsius by pressing the button.
- 9) Power Display: The battery logo will flash when charging, and it will stop when the battery is fully charged.

- 3 -

CAUTION & ATTENTION

- 1) Terpseals Jar is fragile and must be kept properly, Please keep away from the reach of children.
- 2) For safety reasons, the plastic bag is exclusively designed for wrapping the vacuum container. To prevent the risk of suffocation, please ensure it is kept away from infants and children. Avoid using this bag in cribs, beds, or playpens, as it is not intended for such purposes and is not a toy.
- 3) Do not store liquid in the jar and never place the jar upside down when there is powder inside.
- 4) When heating, none of the components of this product should be directly exposed to open flame or an induction cooker to prevent thermal deformation and damage.
- 5) Please note that the lid and batteries in Terpseals are precision components. Do not place the lid in microwave for heating or expose it to temperature below 32F / 0C. The container is Made of Plastic Anti UV, with a heat resistance range of 0 ~ 200 °F / -17 ~ 93 °C. RANGE TEMPERATURE 0 ~ 200 °F / -17 ~ 93 °C.
- 6) To clean Terpseals Jar and lid, do not submerge the lid in liquid, and it is strictly prohibited to clean it with water at temperatures above 140F/60C, Do not use steel wool, abrasive cleaners, or corrosive liquids (such as gasoline, acetone) to clean the product. Do not put the lid in the dishwasher for cleaning. THE LID CONTAINS BATTERY!
- 7) Seals the best terps! Terpseals need the terps!

- 4 -

SEAL AND VACUUM YOUR TERPS LIKE NEVER BEFORE

- 1) Clean the jar after every usage; you can use a damp cloth and then dry the surfaces with a dry one. USE A DAMP CLOTH.
- 2) Ensure Terpseals is dry and clean before using and storing it.
- 3) Keep Terpseals in a dry place and away from direct sunlight.
- 4) Seal the terps.

TERPSEALS PARAMETERS

Rated Wattage: 3W

Rated Voltage: 5V

This symbol indicates that the product cannot be disposed of as ordinary waste in accordance with the WEEE Directive (2002/96/EC) and current local regulations. The product must be disposed of as a separate collection system, such as an authorized collection point for the "WEEE" principle, where old electrical equipment is taken back upon purchase of new ones, or at an authorized disposal facility for waste from domestic electrical and electronic equipment.

Improper management of this type of waste can have a negative impact on the environment and human health due to potentially hazardous substances produced by electronic equipment. Proper disposal of such products will also contribute to efficient use of natural resources. For further information on collection and recovery centers for waste from domestic equipment, please refer to the WEEE Directive and contact the relevant authorities. Correct disposal of these products will also contribute to efficient use of natural resources and avoid administrative sanctions as per Article 30 and subsequent articles of Legislative Decree 22/97.

PRODUCED AND IMPORTED BY
BELTRAME MARCO
Via Goffredo Mameli 8, Bovisio Masciago, 20813, Italy
info@terpseals.com

Made in China

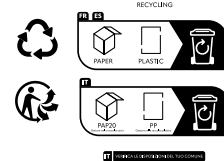

- 5 -